

Model: 6366XXXX

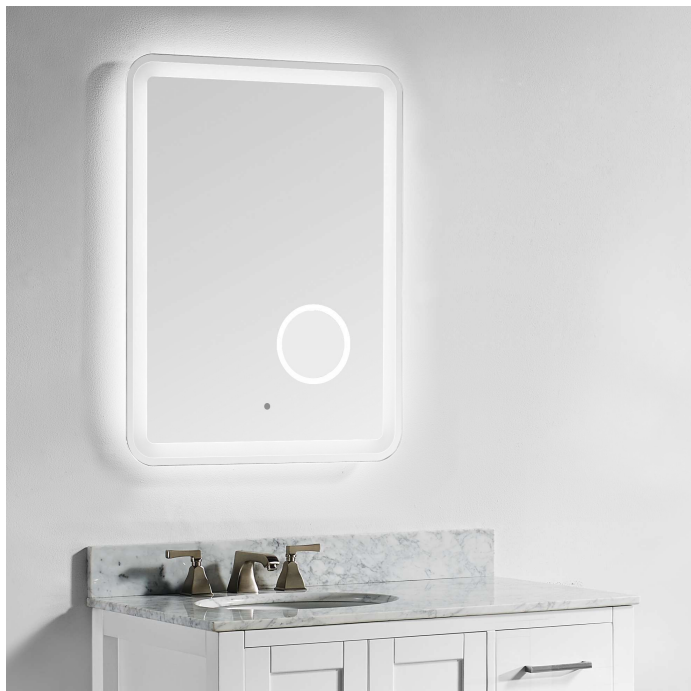

FEATURES

- Elegant Rounded Corner Design
- Energy Efficient and Long Lasting LED Lighting
- Frosted pattern on four sides
- 5mm Copper-free Mirror
- Mirror Front IR Sensor Switch
- Built-in 5.5" Dia. LED Lit Magnifier with 3x Magnification
- Durable Aluminum Frame with Steel Back Panel
- Can be Hung in Portrait or Landscape (for 63662432 and 63663632 ONLY)
- Surface-Mount with French Cleat Mounting Bracket
- Hardwired (Junction box required)

LIGHTING

- Fron-facing & Back-lit Lighting
- Average Bulb Life of 50,000 hours
- CRI: 85+
- Color Temperature: 6000K (Daylight)
- Brightness & Power Consumption: See Page 2
- Power Requirements: 110-130V AC, 60Hz

SAFETY

- Safety Backed Mirror
- IP44 Rated
- UL Listed

OVERVIEW

innoci-usa does not cut corners and only uses the highest quality components and bulbs to make sure that the mirror will be maintenance free and function like the day you purchased for average 50,000 hours of use. **innoci-usa** prides itself on providing unmatched price vs quality for all of our products. All mirrors come with a 5-year limited warranty.

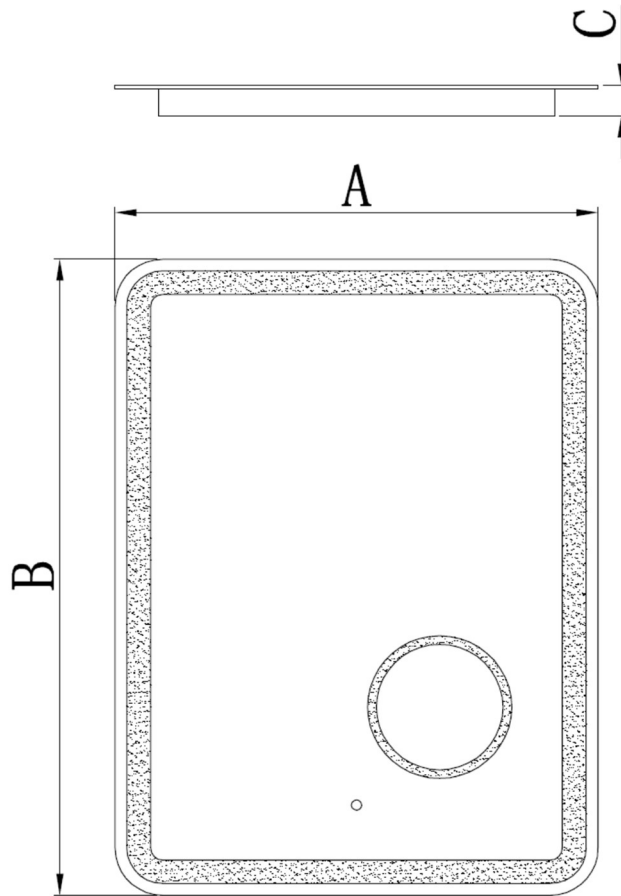

Model #	A	B	C	Brightness (Lumen)	Power Consumption (Watt)
63662432	24	32	1 5/8	1800	29
63663632	36	32	1 5/8	2190	35
63664832	48	32	1 5/8	2550	41
63666028	60	28	1 5/8	2790	45

innoci-usa Inc.
Newport Beach, CA 92660

www.innoci-usa.com
(866) 479-8076

customerservice@innoci-usa.com

innociusa
LIFESTYLE